

LORDS CROSSING

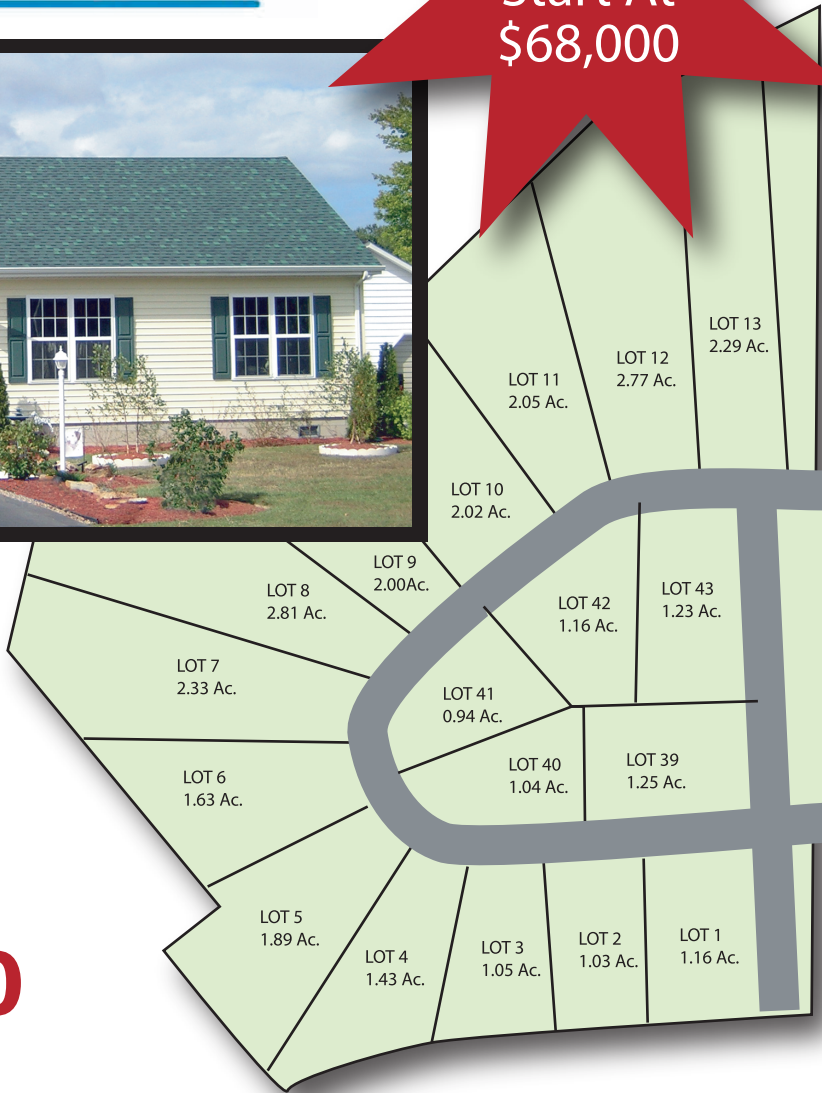

**1 Acre Lots
Start At
\$68,000**



PHASE I

**HOUSE/LOT
PACKAGE
STARTING AT
\$194,900**

New Horizon is introducing an Exciting New Subdivision located on the Eastern Shore in scenic Dorchester County. New Horizon is offering "The Warwick" a 3 bedroom / 2 bath home on over an acre of ground starting at \$194,900. New Horizon will manage your entire construction project. Call today to set up an appointment for information on this limited time offer.

100% FINANCING AVAILABLE TO QUALIFIED BUYERS



NEW HORIZON, LLC
Custom Modular Homes



MHBR
2589

3113 OCEAN GATEWAY • CAMBRIDGE, MD 21613
PHONE: 410-228-9480 • FAX: 410-228-9481 • SALES@NEWHORIZONLLC.COM